

O334 Abbott Accent Table
 Assembly Instructions

- STEP 1:** Invert C-table top onto a clean, smooth surface
- STEP 2:** Attach each A-leg to top using 1 F-short bolt. Do not tighten completely.
- STEP 3:** Attach D-shelf to bottoms of A-legs matching dowel holes. NOTE: You may have to pull slightly on the legs to get the dowels lined up so the shelf is seated.
- STEP 4:** Attach each B leg to bottom of D-shelf using a J-long bolt. This bolt goes through the B-leg and the D-shelf then into the threading in the bottom of the A-leg. NOTE: You may need to move the A-leg slightly and hold it in place as you screw in the bolt to make sure it goes into the threading. Do not tighten completely.
- STEP 5:** Put the E-bottom drawer shelf onto the B-legs matching the dowels to hold it in place. Take the drawer out of the shelf and insert an F-short screw and l-washer through the shelf and into the threading on the bottom of the B-legs. Again, you may have to move the legs slightly to get the bolts into the threading. These can be fastened securely.
- STEP 6:** Go back and tighten all bolts then turn table upright. Now you are ready to enjoy your Abbott Accent Table.

ASSEMBLY INSTRUCTION

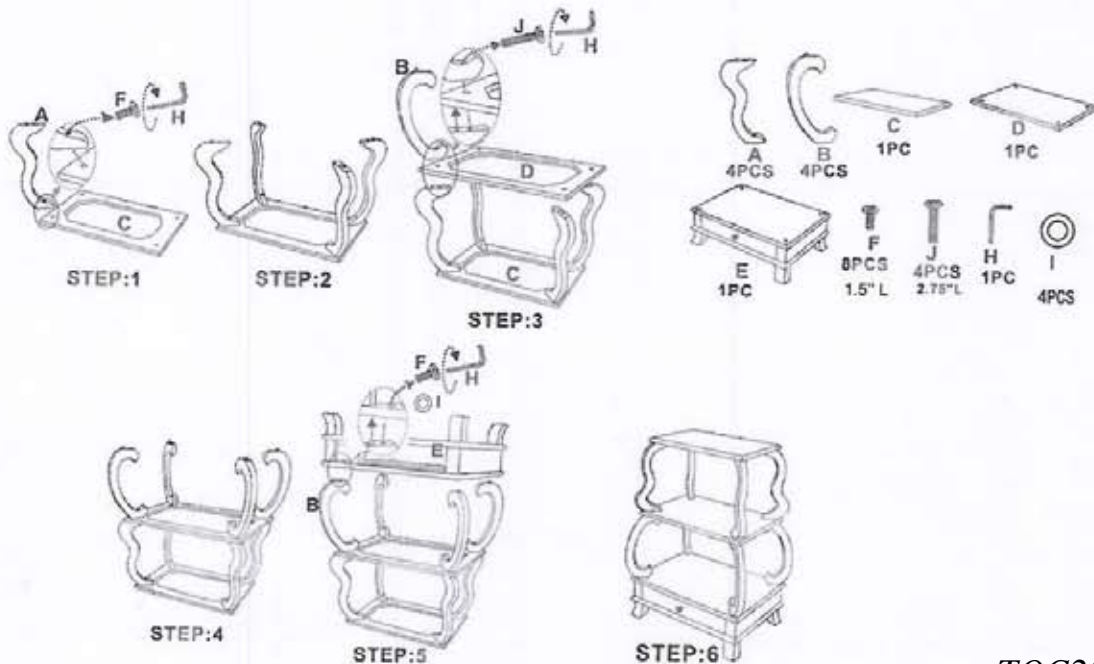

TOC20120423