



Achim's Family of Home Furnishings
Thanks you for your most recent purchase.
We are confident this product will bring you
Years of pleasure and enjoyment!

HONEYCOMB

CELLULAR SHADE

**Make sure to read the instructions before
starting your installation!**

Instruction Manual: Honeycomb Cellular Shade

Step 1: Getting Started

- i. Tools you may need to install your shade: pencil, step-ladder, drill and bits, a cutter knife and screwdriver.
- ii. Inside the hardware kit you will find:

Part	Quantity
Mounting bracket	2 (Shade up to 36" wide)
	3 (Shade up to 50" wide)
	4 (Shade up to 72" wide)
1" Mounting Screw	2 per bracket

Step 2: Measuring Your Window Frame:

Inside Mount:

- i. Measure the width and height of the opening (*See Illustration*).
- ii. Inside mount requires a minimum 1 1/4" (if the depth is less than 1 1/2" mount on outside).



window frame's
mounting depth of at least

Outside Mount:

- i. Measure the area of the window you overlap on the surrounding wall. (*See Illustration*).
- ii. To allow space for mounting brackets, flat surface above the opening.



want to cover, including any
you must have at least 2" of

Step 3: Installing the brackets:

Inside mounting: Mount the brackets to the top of the window frame and use the top bracket holes to secure brackets.

Outside mounting: Center the shade over the window opening at the desired height and use the rear bracket holes to secure brackets.

Position the brackets about 1/2" to 2" from the end of the head rail and be sure to avoid placing brackets over the cord spool. For wider shades that require 3 or more brackets, these should be evenly spaced between the two



outmost brackets. When mounting the brackets ensure that they are aligned with each other to allow proper installation of the head rail.

Step 4: Securing the head rail

Lift the head rail into position such that the front edge of each bracket is under the head rail. Push the head rail upwards until the flexible tab at the bottom of onto the back of the head rail. Check carefully to assure that each bracket is

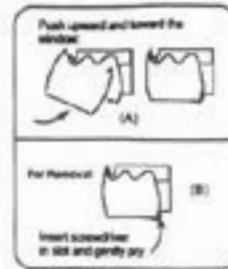

the inner front edge of each bracket snaps properly secured

Step 5: Shade Operation:

Use the single cord to raise & lower the shade. To release the cord so that the shade can be lowered or raised, tug the cord back toward the left edge of the shade. To lock into place, move the cord back to the centre with a light tug.

WARNING/HAZARDS

Keep cords out of children's reach. You can use one of these devices available at your local hardware stores: Cleat, Clamp or Clothes Pin, Tie downs

And remember to always follow these basic window-cord safety rules:



Install cordless window coverings in children's bedrooms and play areas. Replace window blinds, corded shades and draperies manufactured before 2001 with today's safer products.



Move all cribs, beds, furniture and toys away from windows and window cords, preferably in another wall.



Keep all window pull cords and inner lift cords out of the reach of children. Make sure that loosened pull cords are short and continuous-loop cords are permanently anchored to the floor or wall. Make sure cord stops are properly installed and adjusted to limit movement of inner lift cords.



Lock cords into position whenever horizontal blinds or shades are lowered, including when they come to rest on a windowsill.

Care & Maintenance for your Honeycomb Cellular Shade

Dust shades regularly. Use soft, clean cloth, dusting mitt or vacuum cleaner with brush attachment (vacuum gently).

If you have any questions regarding installation please call Achim's Customer Service at 1-800-54-ACHIM

www.achimonline.com

Made in China
2008